



PROTECTRON ELECTROMECH (P) LTD

DESCRIPTION :BLADE FUSE - SOLDER TYPE (SHORT LEG TYPE)

PART NO: PTF 200 In-SN

MATERIAL AND FINISH

BODY : NYLON 66, UL 94-V2
ELEMENT : ZINC MATERIAL, TIN PLATED

DESIGN STANDARDS :

1. U.L. STANDARD FOR AUTIOMOTIVE BLADE TYPE FUSES.

RATED VOLTAGE : DC 32 OR LESS
INTERRUPTING RATING : 1000A @ 32V DC

MARKINGS ON THE FUSE CAP SHOULD BE AS FOLLOWS:-

'AMPERAGE', 'VOLTAGE RATING' AND 'PROTECTRON' (MANUFACTURER)

ELECTRICAL CHARACTERISTICS:-

% OF AMPERE RATING	AMPERE RATING	OPENING TIME
110%	25-40Amp	100 Hours Min.
135%	25-40Amp	750 msec., Min.; 1800sec, Max.
200%	25-40Amp	150 msec., Min.; 5sec, Max.
350%	25-40Amp	40 msec., Min.; 500msec., Max.

FOR DWG REFER NEXT PAGE



PROTECTRON ELECTROMECH (P) LTD

DESCRIPTION :BLADE FUSE - SOLDER TYPE (SHORT LEG TYPE)

PART NO: PTF 200 In-SN

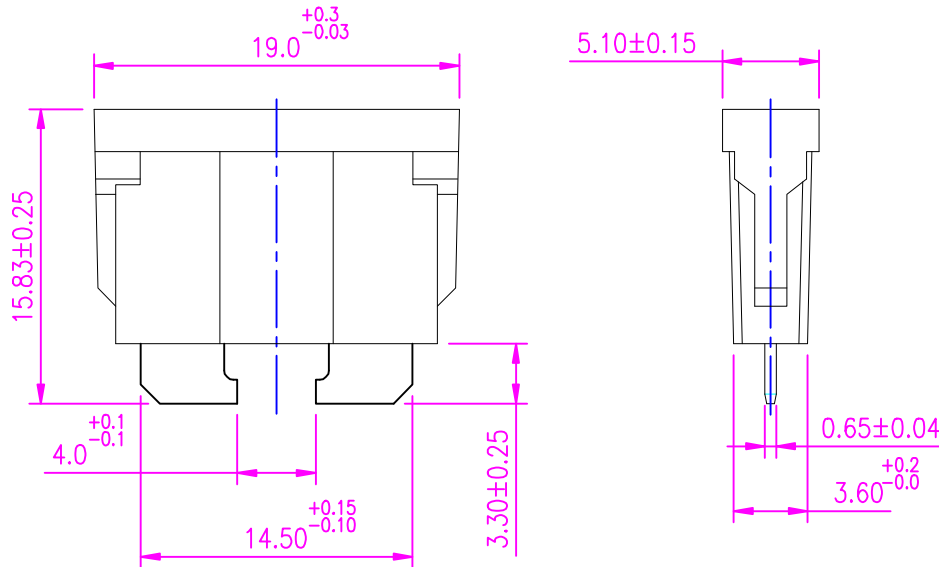

ORDERING INFORMATION

I_n = NOMINAL CURRENT(25A TO 40A)

NOMINAL CURRENT RANGE (I_n)	BODY COLOUR	PART NUMBERS
25A	NATURAL	PTF 200 25A-SN
30A	GREEN	PTF 200 30A-SN
40A	ORANGE	PTF 200 40A-SN

A1	TOLERANCE CHANGED		02.12.2016		
A	ORIGINAL	SACHIN	24.01.2012		
REV.	DESCRIPTION	DRN. BY	DATE	CK'ED BY	APP'D BY

Projection:



Scale: NTS

Sht. Size: A4

Gen. Tol.: $\pm 0.1\text{mm}$
 $\pm 0.2'$

ALL DIMENSIONS ARE IN MM.
IF UNLESS OTHERWISE SPECIFIED.